

## OmniLogic®

### Chlorination Operation (When Not Controlled By ORP)

The following information explains how the OmniLogic® chlorination option works when the Sense & Dispense (ORP) is not used to control chlorination. This information is located in the OmniLogic® Operation Manual for further reference. If a chlorinator has been set-up in the Configuration Wizard, access to the chlorination settings can be found within the 'Pool Features' menu.

#### Chlorinator Control Screen

Locate the "Chlorinator" icon within the pool features menu and select it to enter the "Chlorinator Control Screen". Here the chlorinator options of setting a schedule, setting the chlorine level, activating super chlorinate, enable/disable the chlorinator can all be adjusted. Access to the chlorinator's diagnostics page is also available on this screen.

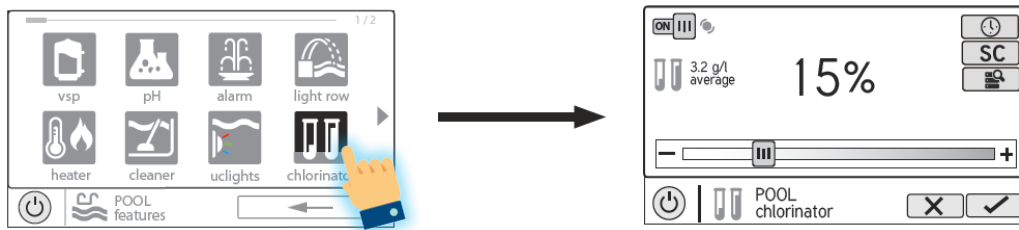

**Enable / Disable** - Slide this switch to enable and disable the chlorinator and then touch the Save button.

**Change Setting** - This slider will raise and lower the chlorinator setpoint setting. If an HLCHEMAU is used and ORP is enabled, the adjustment will be displayed in "mV".

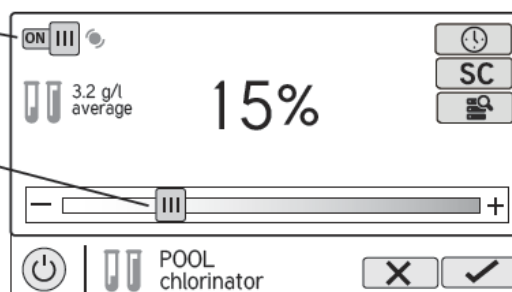

**Set Schedule** - Touch this button to set a schedule for the chlorinator.

**Super Chlorinate** - Touch this button to set the amount of hours that you'd like to super chlorinate.

**Chlorinator Diagnostics** - Touch this button to view diagnostics, set average salt, change polarity, and to reset the cell timer.

Chlorinator Control Screen

#### Chlorinator Setting

The OmniLogic® can only generate chlorine while the main filter pump is operating. Set the percentage of run time that you desire chlorine generation. Raise this value to generate more chlorine. Lower this value to generate less.

*NOTE:* After the initial setting, you may need to raise the setting when the pool water temperature increases significantly, when there is higher than normal bather load or when your chlorinator cell ages. You may need to lower the setting when the pool water temperature decreases significantly or there are long periods of inactivity.

#### Super Chlorinate

When you have an unusually high bather load, a large amount of rain, a cloudy water condition, or any other condition that requires a large amount of chlorine to be introduced to the pool, activate the OmniLogic® Super Chlorinate function.

*NOTE:* The OmniLogic® will turn on the filter pump (if not scheduled), set the pool/spa valves to the correct position, and set the chlorine generator to maximum output. The "Super Chlorinate" function will continue for the programmed number of hours overriding the normal filter pump schedule settings. At the end of the "Super Chlorinate" period, the pool will return to normal operation. If you manually turn off the filter pump, the "Super Chlorinate" function terminates.

## Operating Conditions

For the chlorinator to be operating, several conditions must be met:

- » The filter pump must be running.
- » The flow switch must detect flow.
- » The chlorinator setting must be greater than 0%.
- » The water temperature at the cell must be between 10°C and 60°C. ('Super Chlorinate' will run under 10°C except during freeze protection).
- » The salt level must be within the operating range of 2700-3400 ppm, (ideally at 3200 ppm or 3.2 g/L).
- » The Hayward Recommended Pool Chemistry levels can be found on the inside of the OmniLogic® door. Maintain the pool water at these levels to ensure optimal equipment operation.

If any of these conditions are not met, the diagnostic screen will show that the chlorinator is off. Also, depending on the chlorinator setting, the OmniLogic® may be in between cycles and the chlorinator is at rest (cell current shows 0.00 A). To force the start of the new cycle, you can touch the 'Reverse Polarity' button.

## Chlorinator Diagnostics Screen

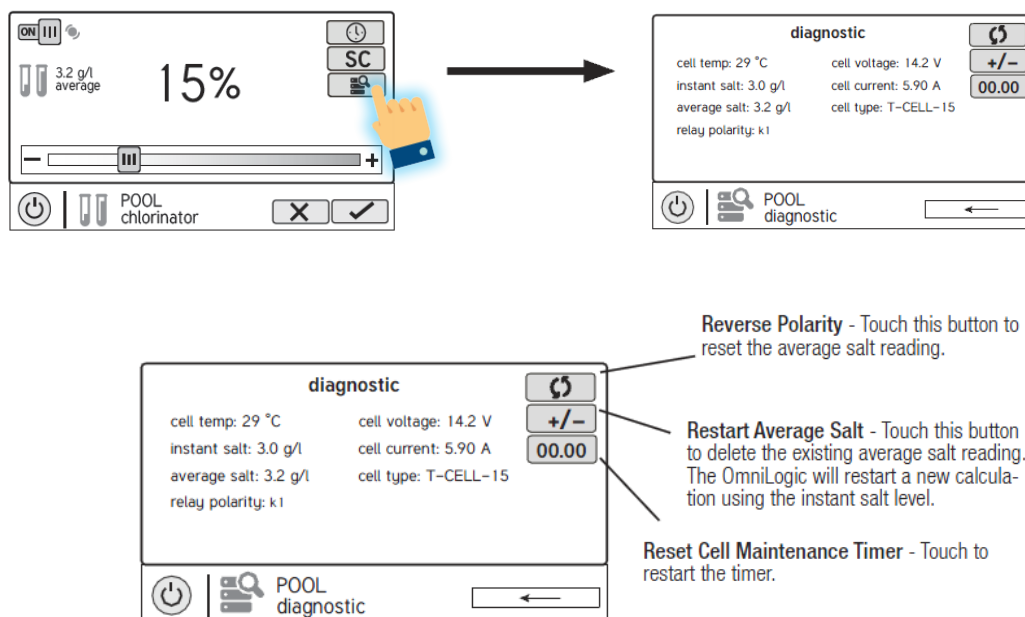

### Restart Average Salt

The OmniLogic® monitors salt level while chlorinating. At any time, go to the chlorinator diagnostic screen to view the average salt based on an ongoing calculated average. If the average salt is restarted, the previous average is deleted and the OmniLogic® begins calculating the new average from that moment.

### Reverse Polarity

The OmniLogic® periodically reverses the polarity of the voltage applied to the chlorinator cell in order to automatically clean off any calcium deposits. To check operation in both polarities, touch this button. The chlorinator will turn off, wait for 15 seconds and then turn on in the opposite polarity.

### Reset Cell Maintenance Timer

The OmniLogic® will remind you to do this by displaying a message to clean and inspect the cell after approximately 500 hours of operation. You can restart the timer by touching this button.